



3 year guarantee

LASER

LASER SPEED

LASER SPEED LIGHT

Ice screw

Broches à glace



WARNING

Activities involving the use of this equipment are inherently dangerous. You are responsible for your own actions and decisions.

Before using this equipment, you must:

- Read and understand all Instructions for Use.
- Get specific training in its proper use.
- Become acquainted with its capabilities and limitations.
- Understand and accept the risks involved.

FAILURE TO HEED ANY OF THESE WARNINGS MAY RESULT IN SEVERE INJURY OR DEATH.

PRICE

Traceability and markings / Traçabilité et marquage

LASER

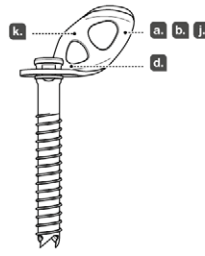

LASER SPEED
LASER SPEED LIGHT

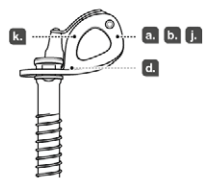

CE 0082

a) Body controlling the manufacture of this PPE
 b) Notified body that carried out the CE type examination
APAVE SUDEUROPE SAS
 8 rue Jean-Jacques Vernazza
 Z.A.C. Saumaty-Séon - CS 60193
 13322 Marseille CEDEX 16
 N°0082

d) Serial number

00 J 0000000 000

e) Year of manufacture
 f) Month of manufacture
 g) Batch number
 h) Individual identifier

j) Read the Instructions for Use carefully

k) Model identification

PETZL.COM



Latest version



Other languages



Technical tips

PETZL
 F-38920 Crolles
PETZL.COM
 ISO 9001
 © Petzl



Sustaining our Community
 Au service de la Communauté
FONDATION-PETZL.ORG



S (10cm)

M (13cm) L (17cm) XL (21cm)

Not PPE
Pas EPI

CE 0082 EN 568 UIAA

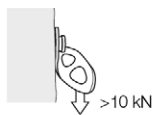
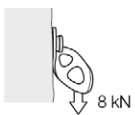

1. **Field of application** (text part)
 Champ d'application (partie texte)

2. **Nomenclature of parts**
 Nomenclature

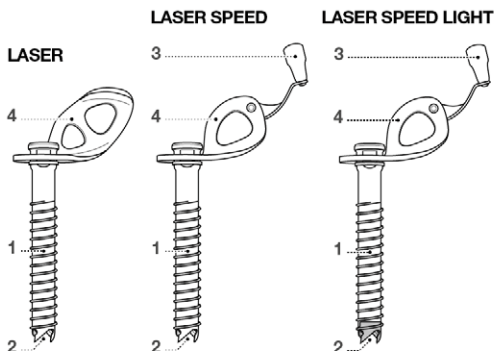

LASER M 120 g L 135 g XL 153 g

LASER SPEED S 113 g M 128 g L 143 g XL 161 g

LASER SPEED LIGHT M 91 g L 101 g XL 111 g

3. **Inspection, points to verify**
 Contrôle, points à vérifier

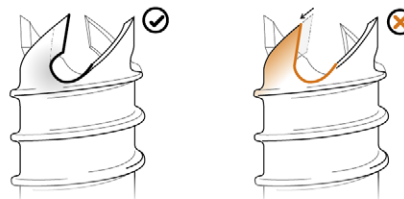
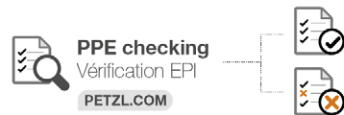

4. **Compatibility** (text part)
 Compatibilité (partie texte)

5. Screwing/unscrewing
Brocher/débrocher

Screwing / Brocher

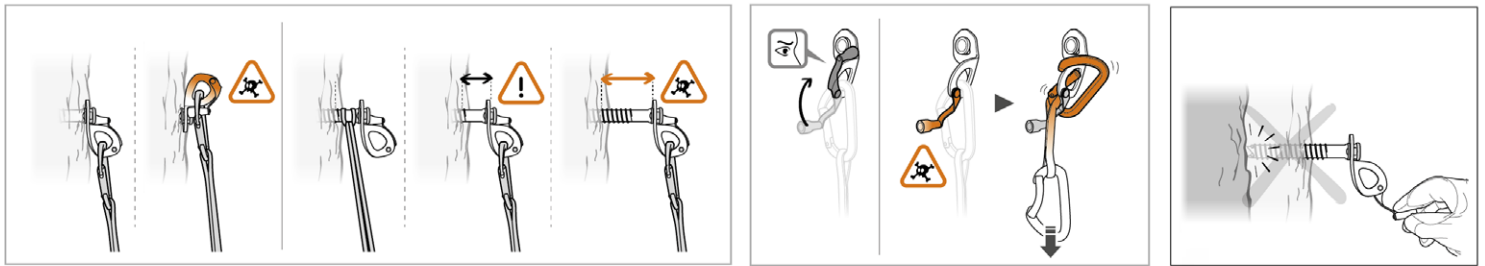
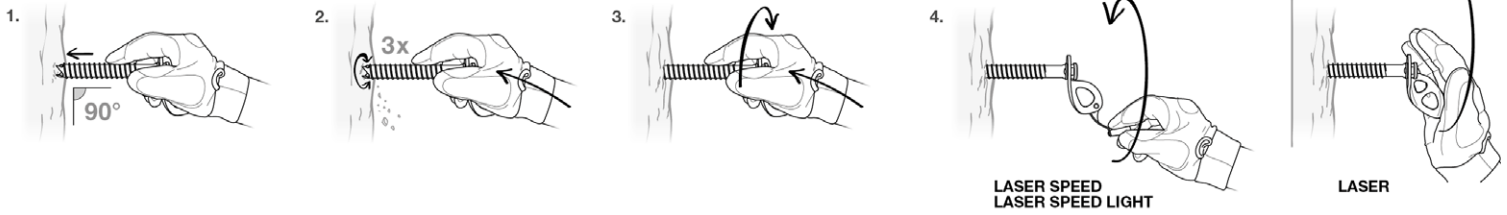

Unscrewing / Débrocher

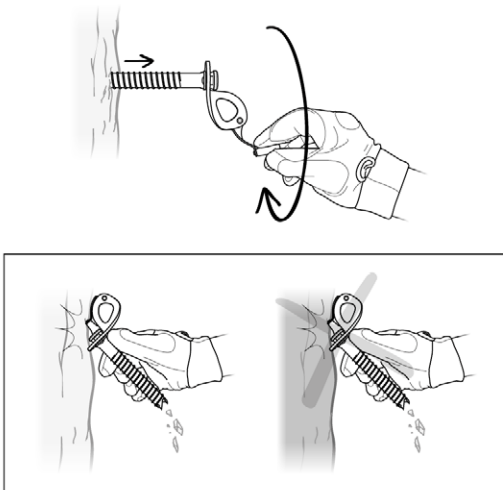

6. Maintenance
Entretien



Accessories
Accessoires

LIM'ICE
V70

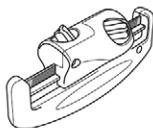

7. Ice screw supplementary information
Informations complémentaires broches

A. Lifetime / Durée de vie



B. Acceptable temperatures
Températures tolérées



C. Precautions for use / Précautions d'usage



D. Cleaning / Nettoyage



E. Drying / Séchage

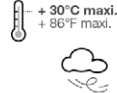

F. Storage / Transport
Stockage / Transport



G. Maintenance / Entretien



H. Modifications - Repairs
Modifications - Réparations



I. FAQ - Contact
Questions - Contact



